

# 8-45 Series Aluminum Extrusions 45, 90mm Square

1 Slot

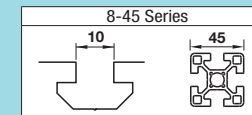

Fixing Parts			Others	
Brackets	Joints	Nut	Extrusion End Caps	Alterations
P.691 ~P.704	P.704 ~P.710	P.713 ~P.722	P.723	P.755 ~P.768

Features: Standard extrusions for equipment bases, etc.

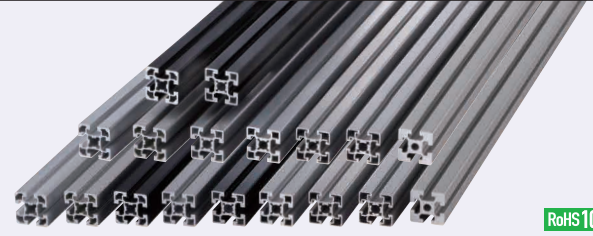

Type		Material	Surface Treatment
Configurable Length	Fixed Length		
GFS8	KGFS8	EN AW-6061-T6 Equiv.	Clear Anodize
NEFS8	KNEFS8	EN AW-6063-T5 Equiv.	
NFSL8	KNFSL8		
EFS8	KEFS8		
HFS8	KHFS8	EN AC-51400-T5 Equiv.	Black Anodize
HFSL8	KHFSL8		Clear Coating (Anodize + Clear Paint)
EFSB8	KEFSB8		
HFSB8	KHFSB8		
CAF8	KCAF8		

RoHS 10

⚠ Cut surface and altered parts are not surface treated.

NEFS8-4545  
EFS8-4545  
EFSB8-4545  
(Black Anodize)

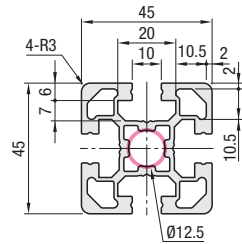

HFS8-4545  
HFSB8-4545 (Black Anodize)  
CAF8-4545 (Clear Coating)

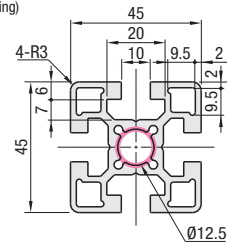

NFSL8-4545  
HFSL8-4545 (Light Type)

⚠ For Slot Covers for HFSL8-4545, use HSCA8 (P.773).

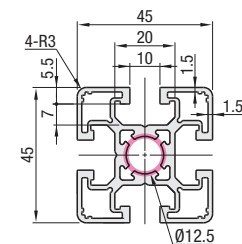

GFS8-4545 (High Rigidity)

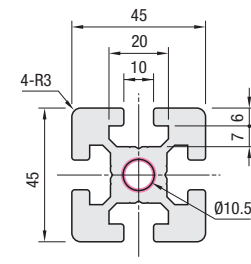

Features: 1-slot Aluminum 45mm Square Extrusions with a Flat Side



RoHS 10

Type		Material	Surface Treatment
Configurable Length	Fixed Length		
GFSF8	KGFSF8	EN AW-6061-T6 Equiv.	Clear Anodize
NEFSF8	KNEFSF8	EN AW-6063-T5 Equiv.	
EFSF8	KEFSF8		
HFSF8	KHFSF8		
HFSLF8	KHFSLF8	EN AC-51400-T5 Equiv.	Black Anodize
HFSFB8	KHFSFB8		

⚠ Cut surface and altered parts are not surface treated.

NEFSF8-4545  
EFSF8-4545

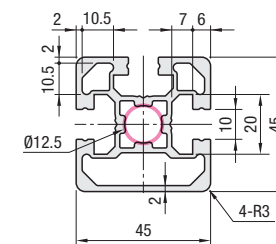

HFSF8-4545  
HFSFB8-4545 (Black Anodize)

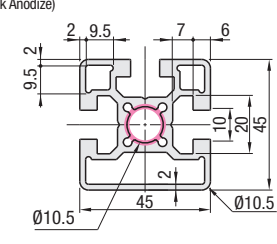

HFSLF8-4545 (Light Type)

⚠ For Slot Covers for HFSLF8-4545, use HSCA8 (P.773).

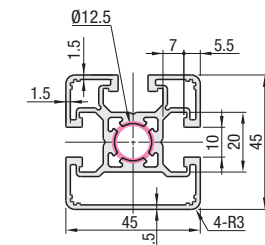

GFSF8-4545 (High Rigidity)

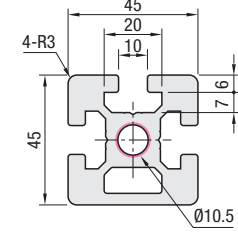

Configurable Length Extrusions

Part Number	L 0.5mm Increment	Mass kg/m	Sectional Area mm <sup>2</sup>	Cross Sectional Moment of Inertia mm <sup>4</sup>		Unit Price (Less than 300mm) 1 ~ 9 pc(s).	Volume Discount Rate Less Than 300mm		Unit Price/m (300mm or More) 1 ~ 9 pc(s).	Volume Discount Rate 300mm or More	
				lx	ly		10-49	50-160		10-49	50-160
NEFS8	4545 ■ Applicable to 6000mm depending on products. Refer to Information of Special Orders (P.103) and contact the person in charge of Special Orders at MISUMI OCT Center. ⚠ Some extrusions are not applicable.	1.93	713	15.42x10 <sup>4</sup>	15.42x10 <sup>4</sup>	1 ~ 9 pc(s).	10-49	50-160	1 ~ 9 pc(s).	10-49	50-160
EFS8											
EFSB8 (Black Anodize)											
HFS8											
HFSB8 (Black Anodize)											
CAF8 (Clear Coating)											
NFSL8											
HFSL8 (Light Type)											
GFS8 (High Rigidity)	3.16	1171	23.64x10 <sup>4</sup>	23.64x10 <sup>4</sup>							

Fixed Length Extrusions (Effective Length 4000mm P.526)

⚠ Part numbers beginning with the character "K" indicate Fixed Length Extrusion.

Part Number	L mm	Sectional Area mm <sup>2</sup>	Cross Sectional Moment of Inertia mm <sup>4</sup>		Unit Price 1 ~ 9 pc(s).	Volume Discount Rate 10-20
			lx	ly		
KNEFS8	4545 4000 (Effective Length)	713	15.42x10 <sup>4</sup>	15.42x10 <sup>4</sup>		
KEFS8						
KEFSB8 (Black Anodize)						
KHFS8						
KHFSB8 (Black Anodize)						
KCAF8 (Clear Coating)						
KNFSL8						
KHFSL8 (Light Type)						
KGFS8 (High Rigidity)	1171	23.64x10 <sup>4</sup>	23.64x10 <sup>4</sup>			

Ordering Example: Part Number - L  
HFS8-4545 - 800  
KHFS8-4545 - 4000

Alterations are available for Alterations Configurable Length Extrusions. For details of alterations, see P.755.

Configurable Length Extrusions

Part Number	L 0.5mm Increment	Mass kg/m	Sectional Area mm <sup>2</sup>	Cross Sectional Moment of Inertia mm <sup>4</sup>		Unit Price (Less than 300mm) 1 ~ 9 pc(s).	Volume Discount Rate Less Than 300mm		Unit Price (300mm or More) 1 ~ 9 pc(s).	Volume Discount Rate 300mm or More	
				lx	ly		10-49	50-160		10-49	50-160
NEFSF8	4545 ■ Applicable to 6000mm depending on products. Refer to Information of Special Orders (P.103) and contact the person in charge of Special Orders at MISUMI OCT Center. ⚠ Some extrusions are not applicable.	1.83	677	14.58x10 <sup>4</sup>	15.00x10 <sup>4</sup>	1 ~ 9 pc(s).	10-49	50-160	1 ~ 9 pc(s).	10-49	50-160
EFSF8											
HFSF8											
HFSFB8 (Black Anodize)											
HFSLF8 (Light Type)											
HFSFB8 (Black Anodize)											
GFSF8											
	1.97	730	13.88x10 <sup>4</sup>	14.58x10 <sup>4</sup>							
	1.60	590	10.88x10 <sup>4</sup>	11.33x10 <sup>4</sup>							
	3.16	1172	24.54x10 <sup>4</sup>	23.36x10 <sup>4</sup>							

Fixed Length Extrusions (Effective Length 4000mm P.526)

⚠ Part numbers beginning with the character "K" indicate Fixed Length Extrusion.

Part Number	L mm	Sectional Area mm <sup>2</sup>	Cross Sectional Moment of Inertia mm <sup>4</sup>		Unit Price 1 ~ 9 pc(s).	Volume Discount Rate 10-20
			lx	ly		
KNEFSF8	4545 4000 (Effective Length)	677	14.58x10 <sup>4</sup>	15.00x10 <sup>4</sup>		
KEFSF8						
KHFSF8						
KHFSFB8 (Black Anodize)						
KHFSLF8 (Light Type)						
KHFSFB8 (Black Anodize)						
KGFSF8						
	590	10.88x10 <sup>4</sup>	11.33x10 <sup>4</sup>			
	1172	24.54x10 <sup>4</sup>	23.36x10 <sup>4</sup>			

Ordering Example: Part Number - L  
HFSF8-4545 - 800  
KHFSF8-4545 - 4000

Alterations are available for Alterations Length Extrusions. For details of alterations, see P.755.